

## Tools Required

Use these tools for easy DIY installation.

Drill + 2mm  
drill bit



Metal tape  
measure



Phillips head  
screwdriver



Pencil



## Components

Before installation, always check to ensure all blind parts and components are present.

Pelmet	1
Left and right mounting brackets	2
Bracket fixing screws	8
Timber fixing screws	8
Base clip	2
Child safety cleat	2
<b>Centre bracket supplied with blind</b>	
Under 90cm	0
120-135cm	1
150-240cm	2

## How to install your blind

### INSIDE MOUNT

An inside mount offers a minimalist, streamlined look. You may get a stream of light coming through on either side of the blind, due to the spacing that's required to accommodate brackets. An important tip if you're considering an inside mount: make sure that you have no obstacles that could disrupt the flow of the blind, including larger window sills and window winders.

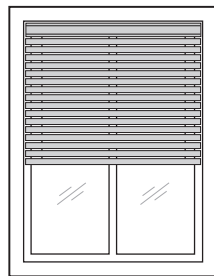

### OUTSIDE MOUNT

With an outside mount, the blind is mounted either on the window frame itself, or entirely outside the frame on the wall. Combined with a pelmet, an outside mount provides a simple and professional finish, and offers greater stylistic flexibility because the sizing of the blind isn't as important.

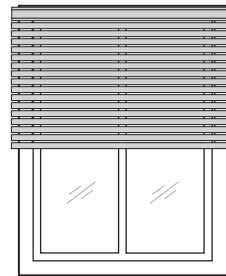

### STEP 1

- Determine if you will mount your blind inside or outside of the window frame.
- Measure width to ensure correct position.
- Using a pencil, mark where the screw holes will go for each bracket.
- Attach the centre brackets supplied if required.

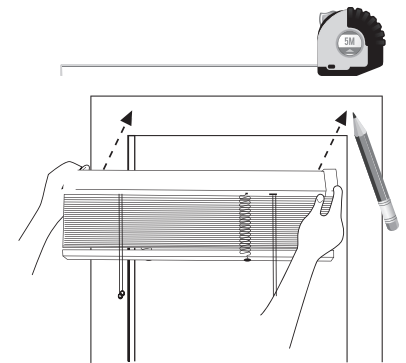

### STEP 2

- Using a 2mm drill bit, drill the pilot holes for each bracket.
- Fix bracket into position using the bracket fixing screws.

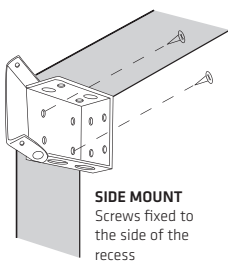

**SIDE MOUNT**  
Screws fixed to the side of the recess

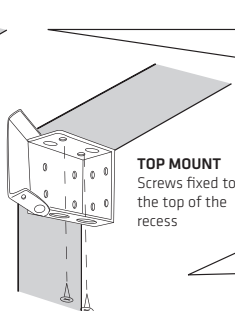

**TOP MOUNT**  
Screws fixed to the top of the recess

#### INSIDE MOUNT

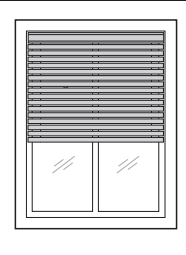

#### OUTSIDE MOUNT

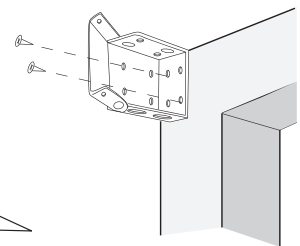
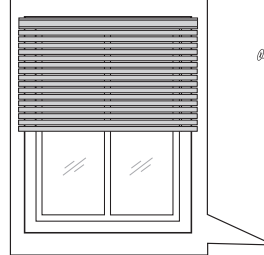

### STEP 3

- With brackets open install head rail in brackets. (Ensure cord lock and tilt cord are to the front).
- Close the brackets firmly until they click into place.

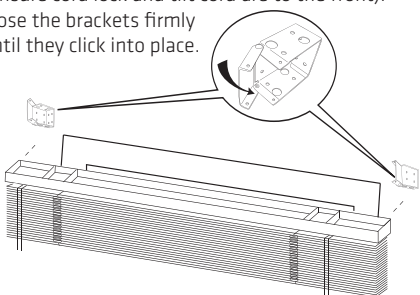

### STEP 4

- Attach pelmet by hooking pelmet brackets over front of head rail.

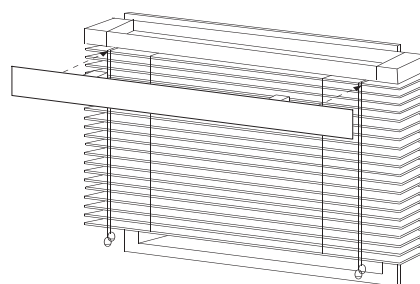

### STEP 5

SEE OVER ►

To view an installation video, scan this QR code.



Requires QR reader app on your smartphone or tablet.

## How to install your blind CONTINUED

**⚠ WARNING:** To avoid creating a possible strangulation hazard for children, the window covering must be installed in such a way that a loose cord cannot form a loop 220mm or longer at a height of less than 1600mm above the floor.

### STEP 5

- Base clips have been provided if you wish to secure the base of your blind to your window reveal or architrave.
- Measure the bottom rail width of your blind and mark the position of the base clip.
- Using a screwdriver, install base clip onto the window reveal, architrave or wall.
- Insert the base clip nib into the side of the bottom rail to secure it tightly.

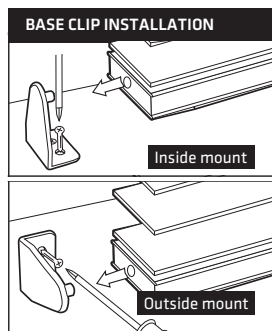

### STEP 6

- Cleat should be fitted to a wall or architrave ensuring that the cord is taut at all times.
- Cord tensioner must be 1600mm above floor level.

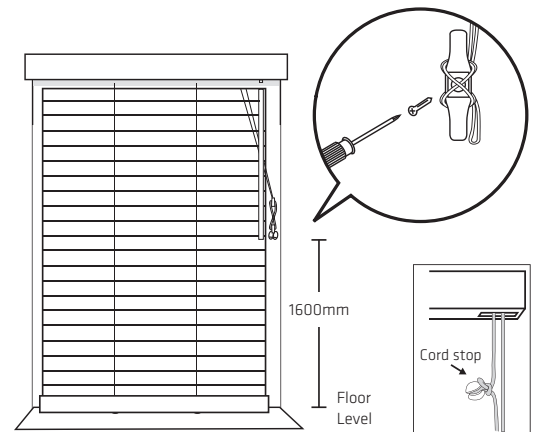

## Great job... enjoy your new Vermont blinds

## How to shorten your blind

### ⚠ WARNING

- A cord guide may be installed lower than 1600mm above floor level if the cord is sufficiently secured or tensioned to prevent a loop 220mm or longer from being formed.
- If a cord guide is installed lower than 1600mm above floor level it must be designed to prevent a child from being able to remove the cord.
- If a cleat is used to secure the cord it must be at least 1600mm above floor level because a child is capable of unwinding a cord from a cleat.

### STEP 1

- Remove bottom plugs and undo the knots for the pull cords.

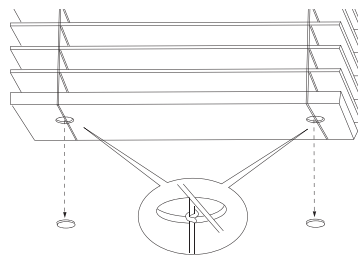

### STEP 2

- Remove slats to desired height, by pulling out central cord and sliding slats out of ladder.

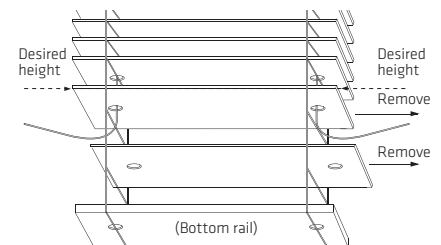

### STEP 3

- Remove bottom rail and replace to new height (by sliding back through ladder).
- Thread pull cord back through bottom rail and redo knots.

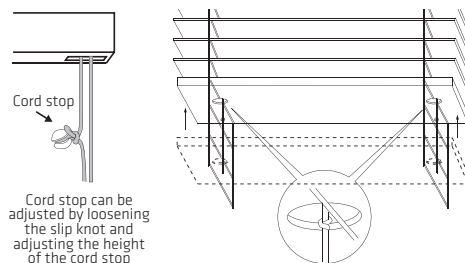

### STEP 4

- Cut excess ladder and cords.
- Cut ladder at least 2mm under the last cross ladder.
- Re-install bottom rail plugs.

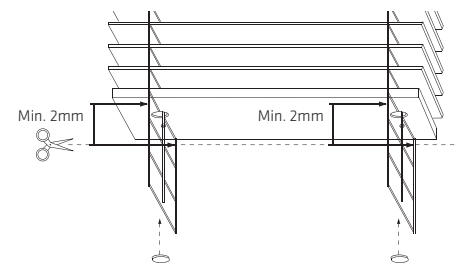

## Well done... you have shortened your new Vermont blinds

## How to maintain your blind

While we understand that there are much better things to do than housekeeping, your blinds will benefit from a regular clean. Children, pets or just general wear and tear can all leave their toll.

**To keep your venetian blinds ship-shape and looking beautiful for years to come, follow these simple tips.**

- Lightly dust the slats with a feather duster or soft cloth regularly.
- Once or twice a year, clean with a venetian blind cleaner.